

Characteristics

- Material**
- Sheet Steel (EN 10130 DC01)
 - Body : 1.2 / 1.5 mm
 - Door : 1.2 / 1.5 mm
 - Galvanized Steel (EN 10346 DX51D+Z)
 - Mounting plate : 1.5 mm
- Surface Finishing**
- RAL7035w powder coating
- Others**
- Fully welded construction
 - Solid + glazed door
 - Foamed-in door PU sealing gasket
 - 135° concealed hinges
 - 5mm Double-bit insert polyamide lock
 - Top and bottom brushed cable entry plates



On Request

- Special sizes
- Special colour
- Pre-punching



Supply Includes

- Body
- Door
- Incoming mounting plate
- Distribution cover plate set
- 4 pcs brushed cable entry plate
- 4/6 pcs wall brackets

Complementary Accessories

- DIN rail
- Door inside mounting profile
- Plastic cover plate
- Special locks and keys
- Earthing cable

Incoming Width	Distribution Width	Height	Depth	Reference	Door	Lock Type	Lock	Hinge	Wall Bracket	Incoming		Distribution		
										Mounting Plate		Cover Plate	Cover Capacity	Total Capacity
A1	A2	B	C							↔	↕	pcs	Module*	Module*
mm	mm	mm	mm		pcs	*	pcs	pcs	pcs	mm	mm			
400	600	600	200	KDS 04060620	1+1	C	2+2	2+2	4	350	530	3	29	87
		800	200	KDS 04060820	1+1	C	2+2	3+3	6	350	730	4	29	116
		1000	200	KDS 04061020	1+1	C	2+2	3+3	6	350	930	5	29	145
	800	1200	200	KDS 04061220	1+1	C	2+2	4+4	6	350	1130	6	29	174
		600	200	KDS 04080620	1+1	C	2+2	2+2	4	350	530	3	39	117
		800	200	KDS 04080820	1+1	C	2+2	3+3	6	350	730	4	39	156
600	600	1000	200	KDS 04081020	1+1	C	2+2	3+3	6	350	930	5	39	195
		1200	200	KDS 04081220	1+1	C	2+2	4+4	6	350	1130	6	39	234
		600	200	KDS 06060620	1+1	C	2+2	2+2	4	550	530	3	29	87
	800	800	200	KDS 06060820	1+1	C	2+2	3+3	6	550	730	4	29	116
		1000	200	KDS 06061020	1+1	C	2+2	3+3	6	550	930	5	29	145
		1200	200	KDS 06061220	1+1	C	2+2	4+4	6	550	1130	6	29	174
800	600	200	KDS 06080620	1+1	C	2+2	2+2	4	550	530	3	39	117	
	800	200	KDS 06080820	1+1	C	2+2	3+3	6	550	730	4	39	156	
	1000	200	KDS 06081020	1+1	C	2+2	3+3	6	550	930	5	39	195	
		1200	200	KDS 06081220	1+1	C	2+2	4+4	6	550	1130	6	39	234

* C: Quarter Turn

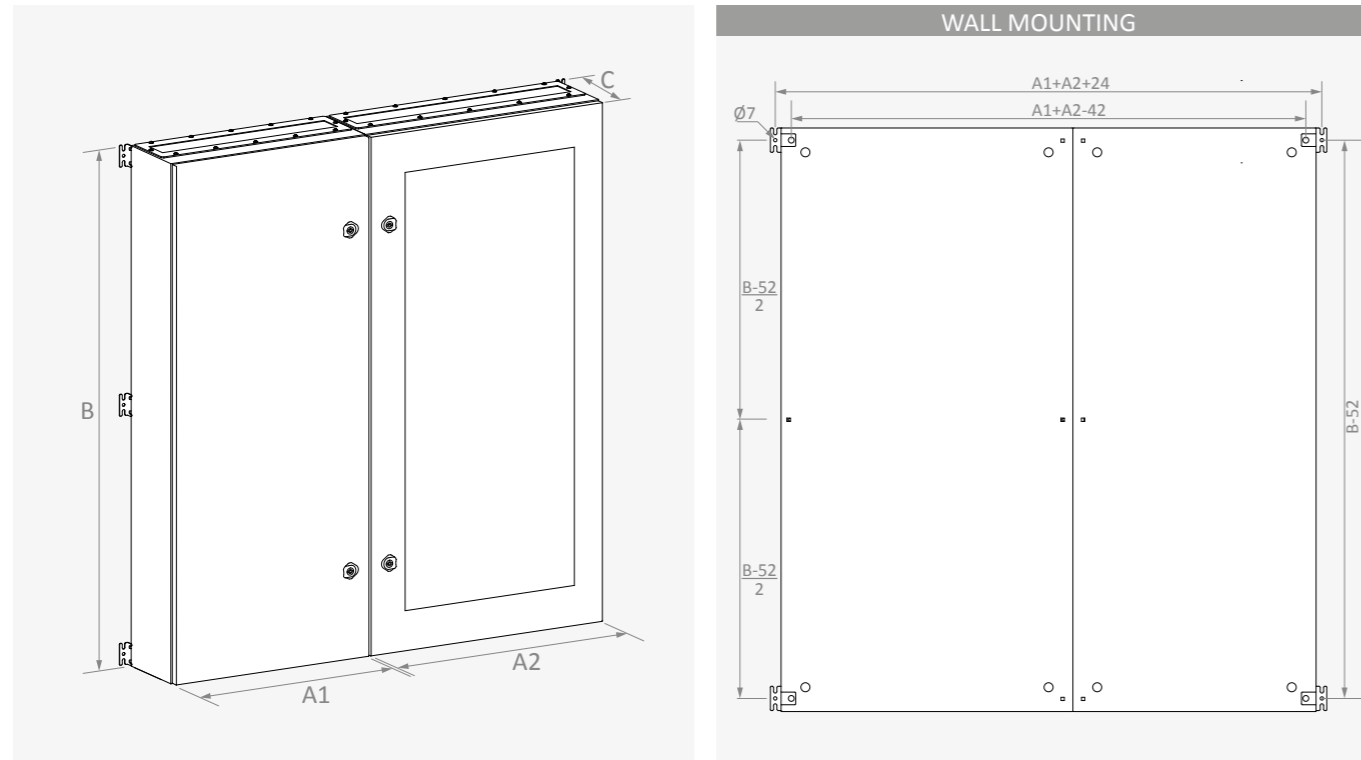

Incoming Width	Distribution Width	Height	Depth	Reference	Useful Area				Glazed Door		Gland Plate			Wall Mounting				
					Incoming Solid Door		Distribution Solid Door		Apparent Area		Incoming			With Bracket		Internal		
					↔	↕	↔	↕	↔	↕	#	↔	↕	↗	↔	↕	↔	↕
mm	mm	mm	mm		mm	mm	mm	mm	mm	mm	mm	mm	mm	mm	mm	mm	mm	
400	600	600	200	KDS 04060620	300	550	500	550	435	450	2 / 2	332	532	140	1024	548	958	548
		800	200	KDS 04060820	300	750	500	750	435	650	2 / 2	332	532	140	1024	748	958	748
		1000	200	KDS 04061020	300	950	500	950	435	850	2 / 2	332	532	140	1024	948	958	948
		1200	200	KDS 04061220	300	1150	500	1150	435	1050	2 / 2	332	532	140	1024	1148	958	1148
	800	600	200	KDS 04080620	300	550	700	550	635	450	2 / 2	332	732	140	1224	548	1158	548
		800	200	KDS 04080820	300	750	700	750	635	650	2 / 2	332	732	140	1224	748	1158	748
		1000	200	KDS 04081020	300	950	700	950	635	850	2 / 2	332	732	140	1224	948	1158	948
		1200	200	KDS 04081220	300	1150	700	1150	635	1050	2 / 2	332	732	140	1224	1148	1158	1148
600	600	600	200	KDS 06060620	500	550	500	550	435	450	2 / 2	532	532	140	1224	548	958	548
		800	200	KDS 06060820	500	750	500	750	435	650	2 / 2	532	532	140	1224	748	958	748
		1000	200	KDS 06061020	500	950	500	950	435	850	2 / 2	532	532	140	1224	948	958	948
		1200	200	KDS 06061220	500	1150	500	1150	435	1050	2 / 2	532	532	140	1224	1148	958	1148
	800	600	200	KDS 06080620	500	550	700	550	635	450	2 / 2	532	732	140	1424	548	1158	548
		800	200	KDS 06080820	500	750	700	750	635	650	2 / 2	532	732	140	1424	748	1158	748
		1000	200	KDS 06081020	500	950	700	950	635	850	2 / 2	532	732	140	1424	948	1158	948
		1200	200	KDS 06081220	500	1150	700	1150	635	1050	2 / 2	532	732	140	1424	1148	1158	1148

WALL MOUNTED ENCLOSURES

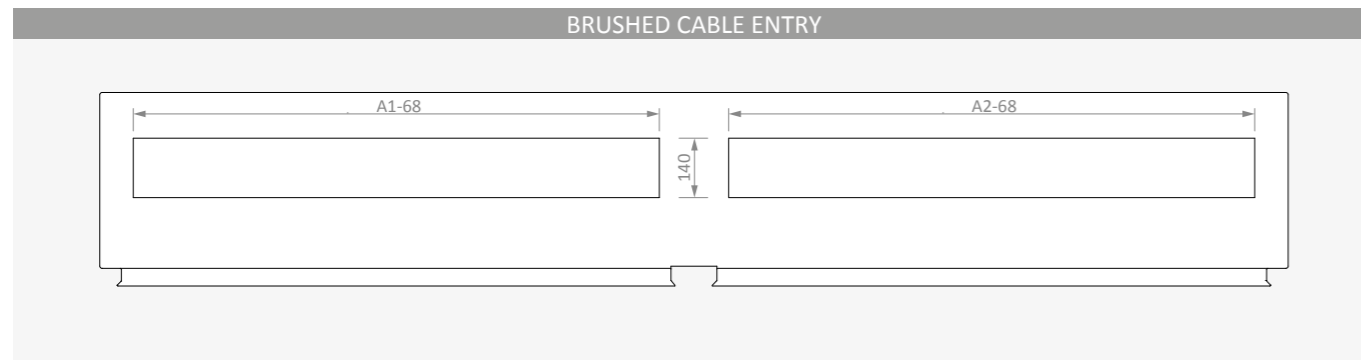
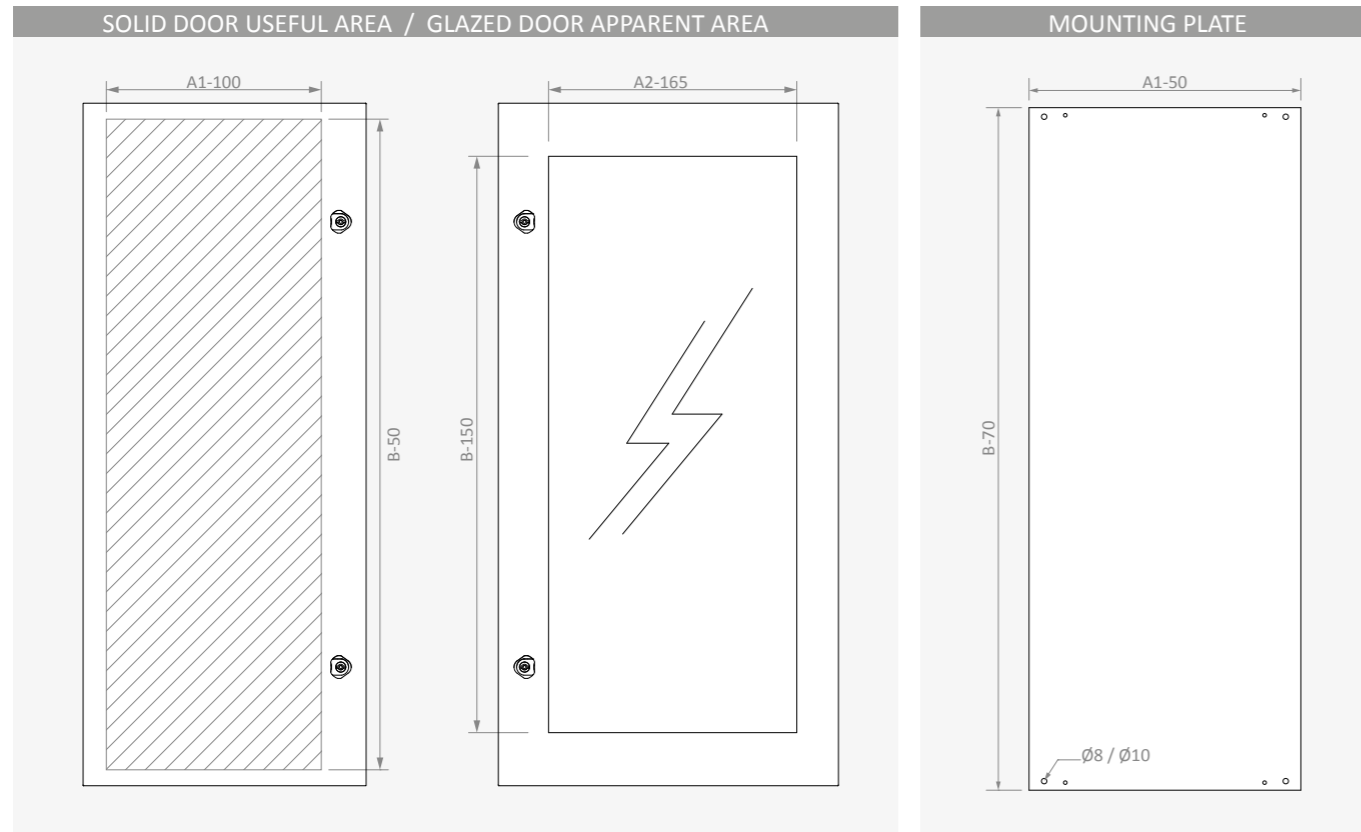

WALL MOUNTED ENCLOSURES

SOLID DOOR

Reference	Incoming Width	Outgoing Width	Height	Useful Area				Lock Type	Lock	Hinge	Weight
				Incoming Solid Door		Distribution Solid Door					
	A1 mm	A2 mm	B mm	W1 mm	H1 mm	W1 mm	H1 mm	*	pcs	pcs	kg
KDS KPG 0406	400	600	600	300	550	500	550	C	2	2	2.3
KDS KPG 0408			800	300	750	500	750	C	2	3	3
KDS KPG 0410			1000	300	950	500	950	C	2	4	3.8
KDS KPG 0412			1200	300	1150	500	1150	C	2	4	4.6
KDS KPG 0606	600	800	600	500	550	500	550	C	2	2	3.4
KDS KPG 0608			800	500	750	500	750	C	2	3	4.6
KDS KPG 0610			1000	500	950	500	950	C	2	4	5.7
KDS KPG 0612			1200	500	1150	500	1150	C	2	4	6.9

Characteristics		Supply Includes	
Material	DIN EN 10130 DC01 CCRS	Lock	
Surface Finishing	RAL7035w powder coating	Hinges	
Thickness	1.2 mm	* C: Quarter Turn	



INCOMING SOLID DOOR USEFUL AREA

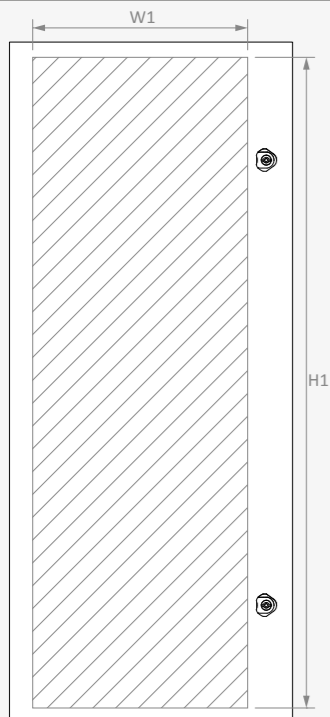

DISTRIBUTION SOLID DOOR USEFUL AREA

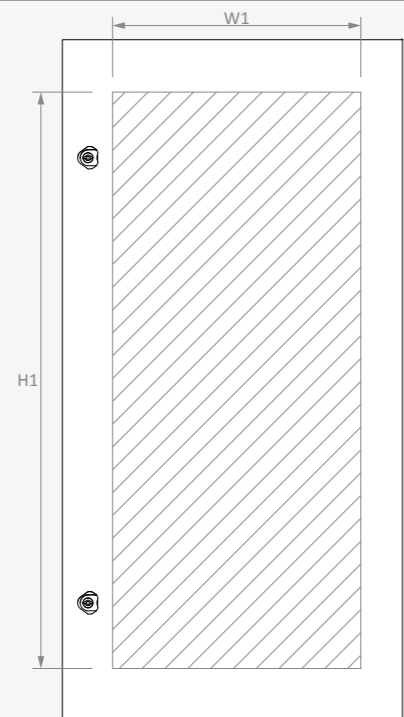

GLAZED DOOR

Reference	Distribution Width	Height	Apparent Area		Lock Type	Lock	Hinge	Weight
			W6 mm	H6 mm				
	A2 mm	B mm	*	pcs	pcs	kg		
KDS KPX 0606	600	600	435	450	C	2	2	3.6
KDS KPX 0608		800	435	650	C	2	3	4.8
KDS KPX 0610		1000	435	850	C	2	4	6.1
KDS KPX 0612		1200	435	1050	C	2	4	7.3
KDS KPX 0806	800	600	635	450	C	2	2	4.8
KDS KPX 0808		800	635	650	C	2	3	6.5
KDS KPX 0810		1000	635	850	C	2	4	8.1
KDS KPX 0812		1200	635	1050	C	2	4	9.7

Characteristics		Supply Includes	
Material	DIN EN 10130 DC01 CCRS / 4mm tempered glass	Lock	
Surface Finishing	RAL7035w powder coating	Hinges	
Thickness	1.2 mm	* C: Quarter Turn	

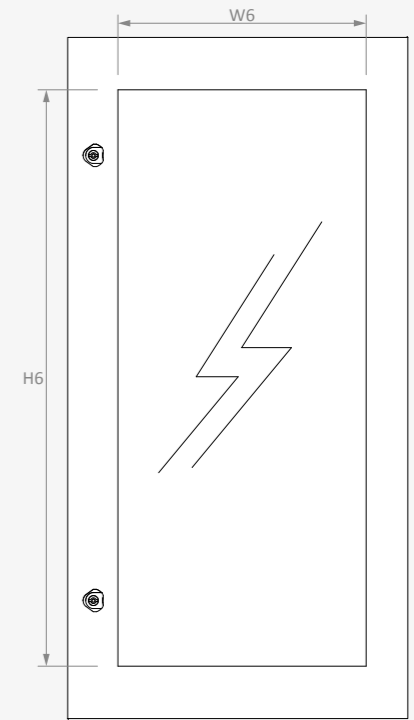

MOUNTING PLATE

Reference	Width		External Dimensions			Mounting Dimensions			Weight kg
	A1 mm	B mm	X1 mm	Y1 mm	Z mm	X2 mm	Y2 mm	D mm	
ETS TS 0406	400	600	350	530	12	300	500	M6	3.1
ETS TS 0408	400	800	350	730	12	300	700	M6	4.1
ETS TS 0410	400	1000	350	930	12	300	900	M6	8.1
ETS TS 0412	400	1200	350	1130	12	300	1100	M6	9.2
ETS TS 0606	600	600	550	530	15	500	500	M8	5.0
ETS TS 0608	600	800	550	730	15	500	700	M8	6.9
ETS TS 0610	600	1000	550	930	15	500	900	M8	8.7
ETS TS 0611	600	1200	550	1130	15	500	1100	M8	10.2

Characteristics	
Material	DIN EN 10327 DX51D+Z galvanized
Thickness	1.5 mm

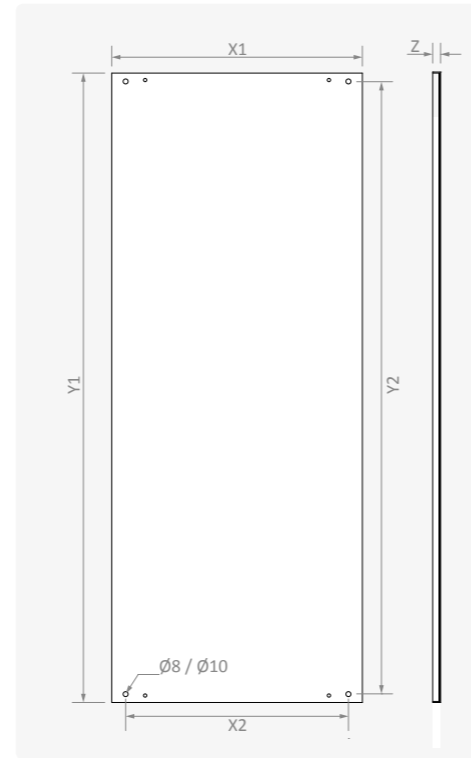

WALL BRACKETS

Reference	Packet	Weight	Characteristics		Supply Includes
	pcs/packet	kg/packet	Material	DIN EN 10130 DC01 CCRS	Wall mounting screws
AK KL 0010	4	0.16	Surface Finishing	Zinc coated Cr ⁺³ passivation	
AK KL 0011	6	0.25	Thickness	2 mm	

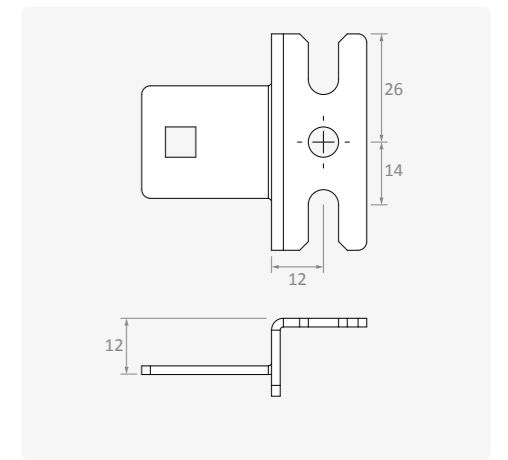

LOCK AND KEYS

Reference	Lock Type	Material		Description	Key Code
		Casing	Cam	Key Type	**
KIATKY2535796T1	C	Polyamide	Polyamide	5 mm Double-bit	KIAN 0100

* C: Quarter Turn; I: Escutcheon
 ** Keys should be ordered separately.

